

KIERAN, TIMBERLAKE & HARRIS

TRANSMITTAL RECORD

TO Bill King
DATE 18 March 1999
PROJECT NUMBER 615
PROJECT NAME Duke University Residential Programming
MODE UPS

Dear Bill,

The enclosed drawings were presented by KTH to the Board of Trustees in December and February. If you need any explanation or have any questions regarding any of the drawings, please let me know.

I am requesting information regarding social change in the dormitories on Main West. KTH is compiling a feasibility report to propose to the Board of Trustees in May. Part of this report will include a social history. We need to convey how the use of the buildings have changed over time. If you have anything relating to this, we would greatly appreciate it. More specifically, I think we need to construct a written timeline of events — the first occupants, the all-male dorms, the co-ed dorms, the social clubs (fraternities), to the present situation. How the buildings were used (commons rooms), how many students to a room, etc. are some of the facts we could use. Again, let me know if you have any questions. Thank you.

Sincerely,

By 4/15

*Real Answer
on Control*

*Call Pichler Th.
re Huxley, dorms, etc*

FROM Karen Moustafellos
COPY TO file

KIERAN, TIMBERLAKE & HARRIS
20 North Third Street, Fifth Floor
The Daniel Building
Philadelphia, PA 19106
T 215 922 6600
F 215 922 4680
E kth@ktharchitects.com

*1 past occupants - which
2
3
4
5
6- anecdotal*

Duke University Archives
Fraternity and Selective Group Housing Changes on West Campus
at Five-Year Intervals, 1930-1990

<u>Fraternities</u>	<u>1930</u>	<u>1935</u>	<u>1940</u>	<u>1945</u>
Alpha Tau Omega	G&H (4th floor)	H 404	C 105	no data
Alpha Pi Sigma		D 406		
Beta Phi Zeta				
Beta Theta Pi			H	
Chi Delta Phi				
Chi Phi			U	
Delta Sigma Phi	R	R 101	R 101	
Delta Kappa Epsilon				
Delta Tau Delta		X 101	X 101	
Goblins	X			
Kappa Alpha	I&J (3rd floor)	G 401	G 103	
Kappa Sigma	BB	BB 101	BB 101	
Keys Club		G 104		
Lambda Chi Alpha	Z	Z 103	Z 101	
Phi Delta Theta	T	T 101	B	
Phi Gamma Tau				
Phi Kappa Psi		E 404	F 103	
Phi Kappa Sigma		G 203	G 206	
Phi Kappa Delta	C(1st floor)			
Phi Sigma Delta	U	G 212		
Pi Epsilon Pi	G(3rd floor)	G 307		
Pi Kappa Alpha	Y	Y 106	Y 106	
Pi Kappa Phi		S 101	S 101	
Psi Delta Sigma	S			
Psi Upsilon				
Sigma Alpha Epsilon		E 204	E	
Sigma Alpha Omega	E (2nd floor)			
Sigma Chi	EE	EE 108	EE 108	
Sigma Delta	K			
Sigma Nu		U 101	A	
Sigma Phi Epsilon	AA	AA 105	AA 105	
Sigma Tau Alpha	A (2nd floor)			
Tau Epsilon Phi				
Theta Chi				
Zeta Beta Tau			T	
<u>Selective Groups</u>				
Arts Dorm				
BOG				
Buchanan				
Canterbury				
Lancaster				
Language				
Lee				
Manchester				
Mirecourt				
Tabard				
Taylor				
Warkwick				
Windsor				
York				

<u>1950</u>	<u>1955</u>	<u>1960</u>	<u>1965</u>	<u>1970</u>	<u>1975</u>
C	C	C	C	C	C
H	H	Wannamaker	Wannamaker 4	WannamakDD AA	Brown (East)
D					
S	S	R&S	R&S	R,S,V	R,S,V
X	X	Wannamaker	Wannamaker 2	Wannamak	Wannamaker 3
G	DD	DD	DD		
BB	BB	BB	BB	BB	BB
D	D	D	D		
B	B	B	B	B	B
F	F	F	F	Z	D
Z	V&Z	CC	CC	DD	F
R	Y R	Wannamaker Wannamaker	Wannamaker 3 Wannamaker 1	Wannamak Wannamaker 4	Wannamaker 2
E	E	E	Y & W	EE	AA GG
EE	EE	EE	EE	EE	EE
A	A	A	A	A	Brown (East)
AA	AA			F	J
U	BB	Z	V	Y & W	Y
T	U T	W&Y T,U,X	E T,U,X	E T,U,X	E
					HH West GG North FF North 2C
					GG West FF West 1A 1B 1C HH East HH South 2A

<u>1980</u>	<u>1985</u>	<u>1990</u>
F	I	I
Brown (East) DD	DD	
R&S Wannamaker 3	R,S,V Wilson IV (East) Taylor	R,S,VO Wilson IV (East) Taylor
B,C BB	Brown (East) BB	Brown (East) BB
B	Y	Burton
O C	O Wilson (East)	O Wilson (East)
Wannamaker 2	York	New Dorms
AA FF-1	AA FF-1	AA FF-1
EE		
Brown (East) J	York EE	Wannamaker 2 EE
non-residential E	E	E
		Mitchell
		Mitchell

West Campus Residential Life Timeline

Year	Buildings	Residential life events	Related campus events	Student affairs administration
1922		Fraternities petition Trustees for permission of acquire their own houses.	Enrollment is 766; only 544 beds available in two-person rooms	
1924	Markham Street properties	College purchases houses and converts them to dormitories; fraternities are housed in them	Creation of the University; preparations for expanding the campus.	
1927	East Campus	New dorms opened; fraternities get sections and common rooms	Opening of East Campus	
1930	Craven, Crowell & Kilgo Quads	Dorm space assigned by lottery. Fraternities get 20-room sections and can rent bedrooms for use as chapter/commons rooms.	Opening of West Campus	William Wannamaker, Dean of Trinity College, assisted by Herbert Herring, Dean of Men
1931				
1932				
1933				
1934				
1935				
1936				
1937				
1938			Centennial Celebration	
1939	Few Quadrangle	A dormitory for graduate students	Centennial Celebration	
1940				
1941			University on war footing	
1942				
1943	Hanes Annex			
1944				
1945				
1946			G.I. Bill affects enrollment	Herbert Herring, Vice President in the Division of Student Life and Dean of Trinity College
1947				
1948				
1949				
1950				
1951	Hanes House			
1952	Trent Drive Hall	Undergrads move into Few Quad.		
1953				

Year	Major reports	Notes	Sources
1922			Archives vertical file: Fraternities and sororities
1924			
1927			
1930			Frank Clyde Brown, Papers. Student Affairs--H.J. Herring. Records
1931			
1932			
1933			
1934			
1935			
1936			
1937			
1938			
1939			
1940			
1941			
1942			
1943		Originally a Nurses' Home	
1944			
1945			
1946			
1947			
1948			
1949			
1950			
1951		Originally a Nurses' Home	
1952		Originally The Graduate Center	
1953			

Year	Buildings	Residential life events	Related campus events	Student affairs administration
1954				
1955				
1956				
1957				
1958	Wannamaker Hall			
1959				
			Gross-Edens Affair	
1960				
1961				
1961/62		First non-Greek selective living groups (theme houses)		
1962			Campus Design Study by Caudill, Rowlett & Scott, Architects & Planning Consultants, of Houston Texas	
1963			CRS Study	
1964			CRS Study, Phase I	William Griffith, Assistant to the Provost in the Area of Student Affairs
1965			CRS Study	
1966	Edens Quadrangle		CRS Study, Phase II	
1967				
1968				
1969				
1969				
1970/71		SHARE, the Student House for Academic and Residential Experimentation, an experimental living-learning project, and the first co-ed dorm since 1896.		William Griffith, Asst. Provost & Dean of Student Affairs

Year	Major reports	Notes	Sources
1954			
1955			
1956			
1957			
1958			
1959			
1960	The West Campus Dormitory Situation / The Subcommittee on the Undergraduate Colleges of the University Committee on Long- Range Planning		
1961			
1961/62		Houses G & H became York and Lancaster Houses.	
1962	MSGA Dormitory Evaluation Commission		
1963			
1964	Undergraduate Life at Duke: A Student Symposium		
1965			
1966			
1967		See Ella Shore's chronology of residential life, 1967- 1993, for details	
1968			
1969	Report of the Committee for Study of Student Residential Life (Strobel Report)		
1969	Student Perspective, 1969		
1970/71			

Year	Major reports	Notes	Sources
1954			
1955			
1956			
1957			
1958			
1959			
1960	The West Campus Dormitory Situation / The Subcommittee on the Undergraduate Colleges of the University Committee on Long- Range Planning		
1961			
1961/62		Houses G & H became York and Lancaster Houses.	
1962	MSGA Dormitory Evaluation Commission		
1963			
1964	Undergraduate Life at Duke: A Student Symposium		
1965			
1966			
1967		See Ella Shore's chronology of residential life, 1967- 1993, for details	
1968			
1969	Report of the Committee for Study of Student Residential Life (Strobel Report)		
1969	Student Perspective, 1969		
1970/71			

Year	Buildings	Residential life events	Related campus events	Student affairs administration
1971		Formation of three co-ed dorms and three federations; some undergrads move to Trent.		
1972			Merger of the Woman's College and Trinity College to form TCAS	
1972		First women's living group is formed on West		
1973				
1974				
1974/75	Central Campus	A few apartments are made available to undergrads.		
1975		Edens Federation formed.		
1976		Maxwell House goes from an all-male cross- sectional to a co-ed group.		
1977				
1978		Relocation of several houses in Few Quad.		
1979				William Griffith, Vice President, Division of Student Affairs. Formation of Residential Policy Committee
1980			Chancellor Pye's <i>Directions for Progress</i>	
1981/82				Implementation Committee formed to ensure fairness in locations; dissolved due breach of confidentiality.
1982/83		De-emphasis of federations; formation of freshman residence hall clusters; major relocations of various living groups, Greek and non-Greek.		

Year	Major reports	Notes	Sources
1971	A Proposal for ... A University Union / Educational Facilities Committee		
1972			
1972			
1973			
1974			
1974/75			
1975	Evaluation of a three-year trial... / Residential Life Committee		
1976			
1977			
1978	Residential Life Committee; ASDU ad hoc Committee on Residential Life		
1979			
1980	Final Report / Residential Life Task Force		
1981/82	Report of the Task Force on Federations. Report of the Task Force on Freshman Clusters. ASDU Report on the Intellectual and Cultural Climate at Duke.		
1982/83			Shore Chronology

Year	Buildings	Residential life events	Related campus events	Student affairs administration
1983/84				Review committee formed to evaluate upperclass living group reports
1984/85		Duke's College Try:" Residential College Task Force		Committee on Overcrowded Student Housing. President's Committee on Residential Life.
1985				Advisory Committee on Overcrowding
1986/87		Changes in a number of living groups	Unusually large freshman class (250 overage)	Student Affairs Task Force on Residential Life. Provost's Committee on Overenrollment.
1987/88		Groups made co-ed, moved, disbanded. Two new groups formed. Decision made to build new residence hall (Schaefer)	Campus Planning Studies, by Dober and Associates, Inc.	
1988/89		Arts Theme House formed.		Residential Task Force formed
1989/90	Schaefer House	Round Table living group formed		
1990/91			Another unusually large freshman class (250 overage)	
1991				Janet Smith Dickerson, Vice President, Division of Student Affairs
1992				
1993				
1994		Residential life task forces		
1994				
1995				
1996		All-freshman East Campus		
1997				
1998				
1999				

Year	Major reports	Notes	Sources
1983/84			
1984/85			
1985			
1986/87			
1987/88			
1988/89	The Intellectual & Cultural Climate at Duke University / ASDU		
1989/90	Black on White / Black on White Steering Committee	Arts dorm	
1990/91			
1991			
1992			
1993	We Work Hard, We Play Hard (Willimon report)		
1994	Arts & Sciences Council Residential Life Committee		
1994	Buliding Community of Interest / Task Force on Intellectual Climate		
1995			
1996			
1997			
1998			
1999			

Section Assignments of Duke Fraternities from 1964 to 1987

Alpha Tau Omega	in C until 1979, moved to F until 1982, moved to I
Beta Theta Pi	in WA1 until 1971, moved to DD
Delta Kappa Epsilon	no section until 1987 when assigned Wilson 1 (had unused space of Phi Kappa Sigma and Sigma Chi in Wilson without commons space from 1982 to 1987)
Delta Sigma Phi	in RSV
Delta Tau Delta	in WA3 until 1982, moved to 1C2
Kappa Alpha	in DD in 1964, moved to YW in 1968, removed from campus in 1970 Returned as a colony and lived with Delta Tau Delta in 1978 and 1979, with Phi Delta Theta and Phi Kappa Sigma in 1980, with Beta Theta Pi, Pi Kappa Alpha, and Delta Tau Delta in 1981, given own section in Brown 2 in 1982
Kappa Sigma	in BB
Phi Delta Theta	in B until 1982, moved to Y until 1987, moved to 1C1
Phi Kappa Psi	in F, moved to Z in 1969, moved to O in 1971
Phi Kappa Sigma	in CC, moved to DD in 1968, moved to J in 1971, moved to F in 1975, moved to C in 1979, moved to Wilson in 1982, to Wilson 2 in 1987
Pi Kappa Alpha	in WA2 until 1982, moved to 2A1, moved to 1B in 1987
Psi Upsilon	colony with Beta Theta Pi as local Chi Delta Phi in 1969, given AA in 1970, there as Chi Delta Phi until 1973 when became Psi Upsilon and still in AA
Sigma Alpha Epsilon	in E in 1964, moved to CC in 1968, moved to GG2 in 1971 as part of Few Fed, moved to FF1 in 1977
Sigma Chi	in EE until 1982, moved to Wilson 3 and given additional space in Wilson in 1987
Sigma Nu	in A until 1971 when moved to Brown as part of Baldwin Fed, became local Omicron Zeta: re-established relationship with Sigma Nu: moved to 2A1 in 1982 and to WA2 in 1987
Sigma Phi Epsilon	in 1966 and 1967 lived as a colony in Wannamaker with other fraternities until given section AA in 1968, moved to F in 1969, moved to J in 1975, moved to EE and DD2 in 1982
Theta Chi	in YW in 1964, moved to E in 1968

The following fraternities had sections during this period, but are no longer Duke resident fraternities:

Lambda Chi Alpha	in D from 1964 to 1969, became local Phi Gamma Tau in 1970, became independent selective house Wellington in 1978. Disbanded in 1982 when relocated to Brown House
Pi Kappa Phi	in Wannamaker IV until 1971 when went to Brown as part of Baldwin Fed: became local fraternity Beta Phi Zeta. Beta Theta Zeta removed from campus in 1982
Tau Epsilon Phi	in Z in 1964 thru 1968, moved to AA in 1969, to YW in 1970. Had Y only in 1973 and until 1978, moved to Z and disbanded in 1979
Zeta Beta Tau	in TUX until disbanded in 1972 and became Maxwell House in 1973

Barbara Buschman
Coordinator, Student Housing
October 6, 1987

WEST CAMPUS DUKE UNIVERSITY

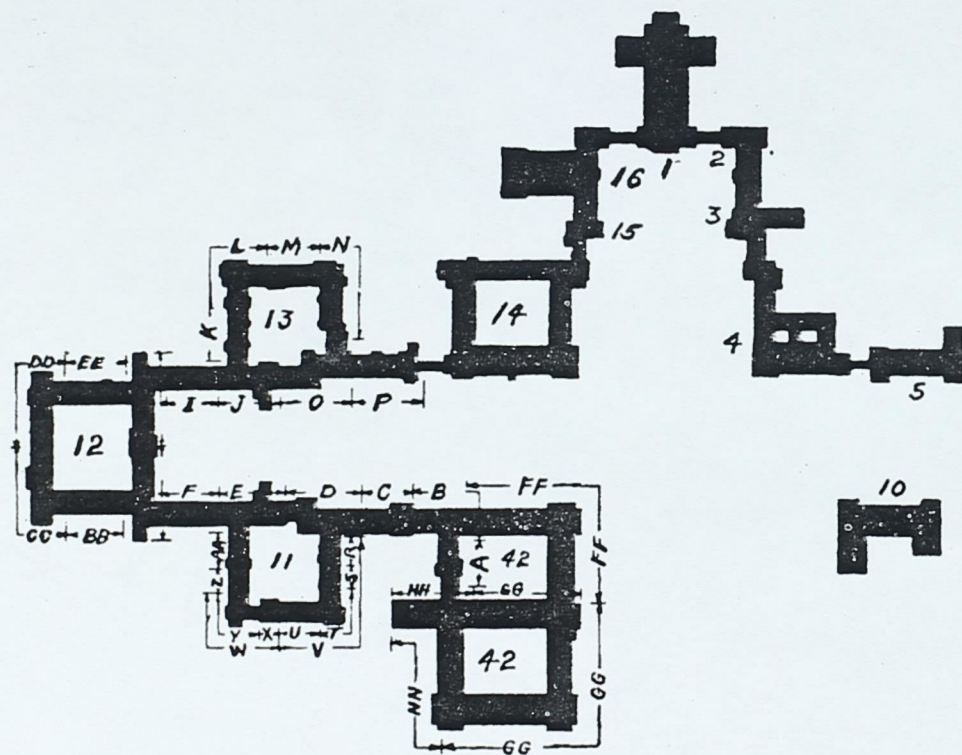

WEST CAMPUS BUILDINGS

1. Chapel
2. Gray
3. Divinity School
4. Library
5. Law School
6. Chemistry
7. Medical School
8. Hospital
9. Biology
10. Physics
11. Craven
12. Crowell
13. Kilgo
14. Union
15. Administration
16. Page Auditorium
18. Nurses' Home
42. Few Quadrangle (Grad.)
47. Engineering Bldg.
49. New Physics Bldg.